

# IEC 320/EN 60320 Power Inlets & Power Outlets (65°C)

## 0722 Screw mounting

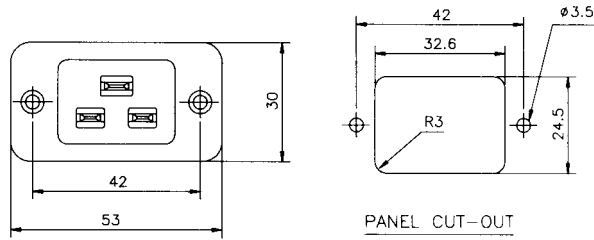

Approvals:  
20A/125V AC-UL, CSA  
16A/250V AC-VDE,  
SEMKO, SEV, NEMKO,  
DEMKO, SETI

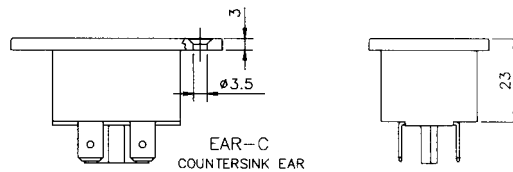

## 0707-1 Screw Mounting

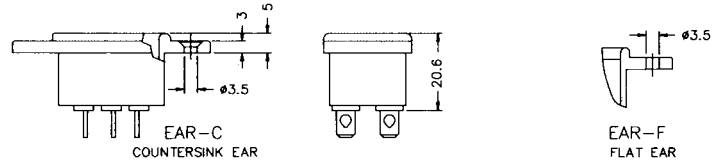
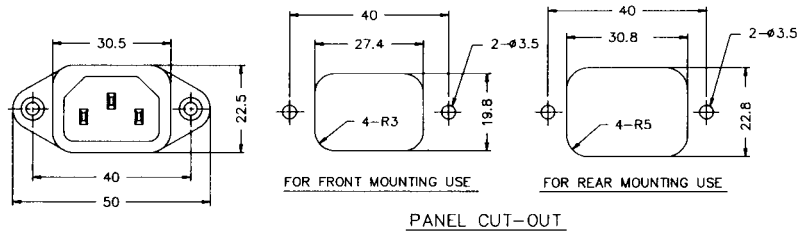

## 0723 Screw Mounting

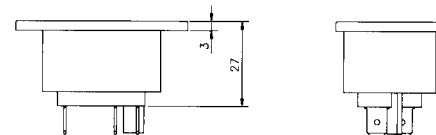
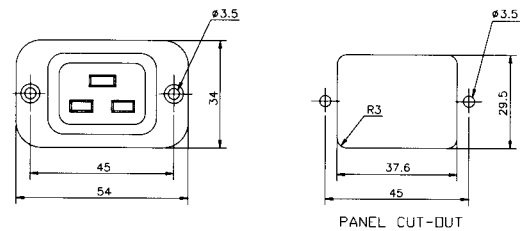

TERMINAL OPTION	CODE	ORDER NO.
4.8mm / .187" O.D. / SOLDER TAB	-Q	0722-CQ 0723-CQ
6.3mm / .250" FAST-ON TAB	-W	0722-CW 0723-CW

# IEC 320/EN 60320 Power Inlets (65°C)

## 0720 Screw Mounting

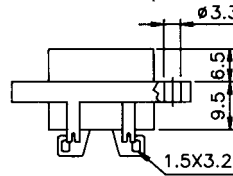
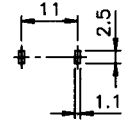
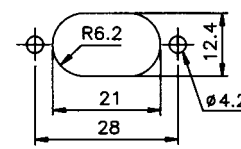
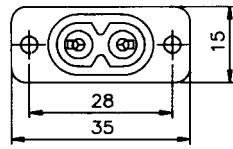

PANEL CUT-OUT

PCB. LAYOUT

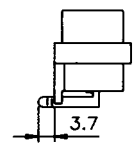
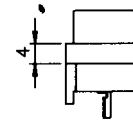

## 0721 Push-in mounting

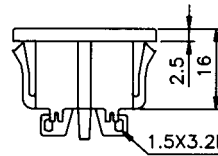
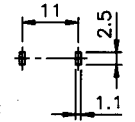
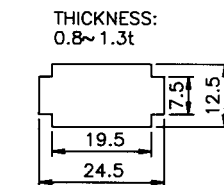
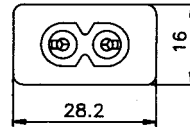

PANEL CUT-OUT

PCB. LAYOUT

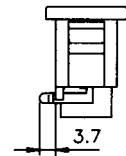
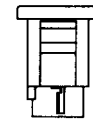

Approvals: 0720 & 0721  
2.5A/250V AC-UL, CSA  
VDE, SEMKO, SEV,  
NEMKO

## 0717 Screw-mounting

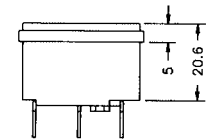
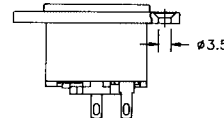
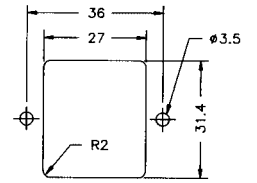
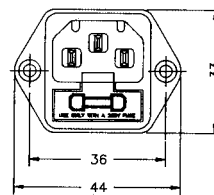

Approvals:  
10A/250V AC-UL, CSA  
VDE, SEMKO, SEV,  
NEMKO, DEMKO, SETI

PANEL CUT-OUT

## 0717-1 Push-in Mounting Power Entry Modules

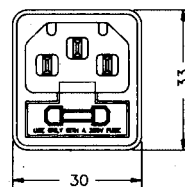
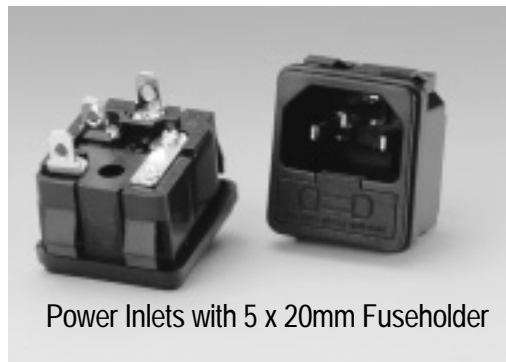

THICKNESS:  
0.8~1.2t(X=31.4)  
1.3~2.0t(X=31.6)

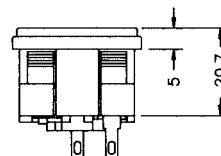
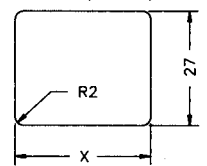

PANEL CUT-OUT

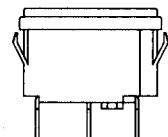

Approvals: 10A/250V  
AC-UL, CSA, VDE,  
SEV, SEMKO,  
DEMKO, NEMKO,  
SETI.

Power Inlets with 5 x 20mm Fuseholder

# IEC 320/EN 60320 Power Inlets & Power Outlets (65°C)

## “Reverse” IEC 320/EN 60320 Connectors used for Accessory Power Connection

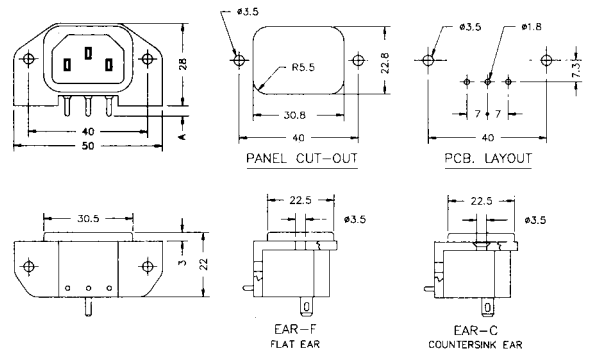
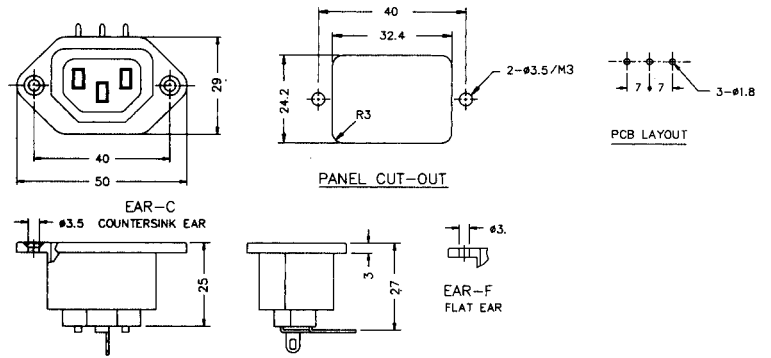

## AC Convenience Outlet (2 wire, rated at 15A/125V AC)

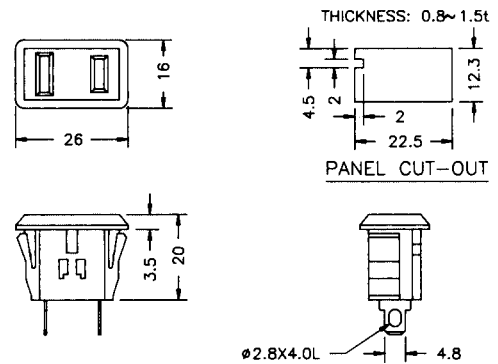

## North American NEMA5-15R Receptacles(3-wire grounding, rated at 15A/125V AC)

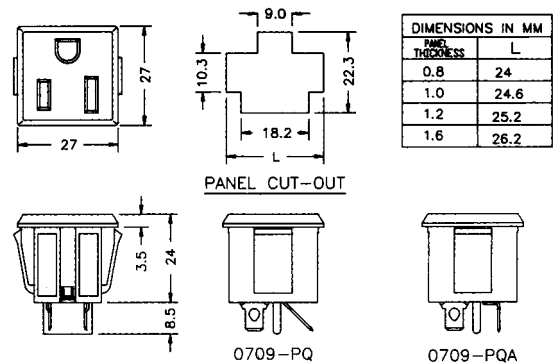

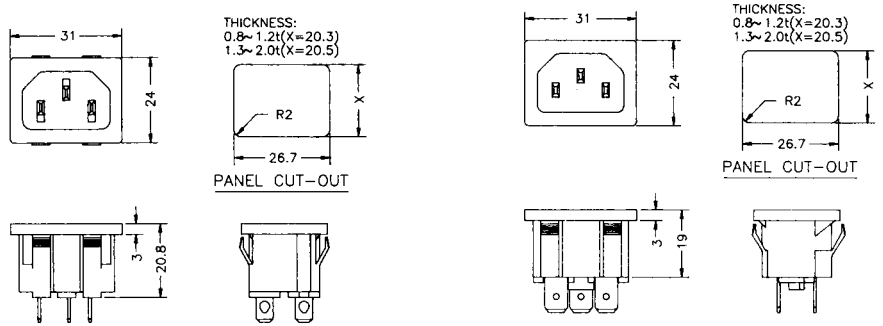

# IEC 320/EN 60320 Power Inlets & Power Outlets (65°C)

## 0711 Push-in Mounting

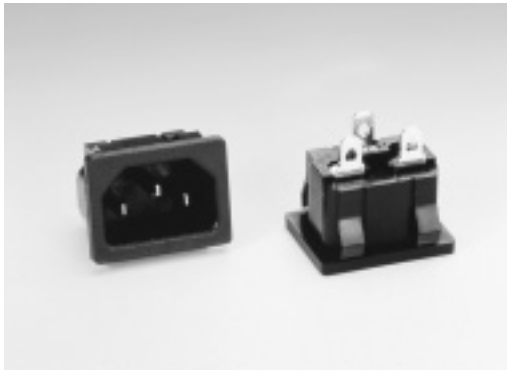

## 0711-1 Push-in Mounting

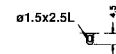
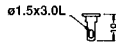
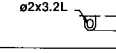
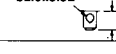

TERMINAL OPTION	CODE	ORDER NO.
2.5mm/SOLDER TAB 	-S	0711-PS 0711-1-PS
2.8mm/SOLDER TAB 	-LS	0711-1-PLS
4.0mm/SOLDER TAB 	-N	0711-PN
4.8mm / 187° Q.D./SOLDER TAB 	-Q	0711-PQ 0711-1-PQ
6.3mm/.250" FAST-ON TAB 	-W	0711-PW 0711-1-PW

## 0718-1 Push-in Mounting

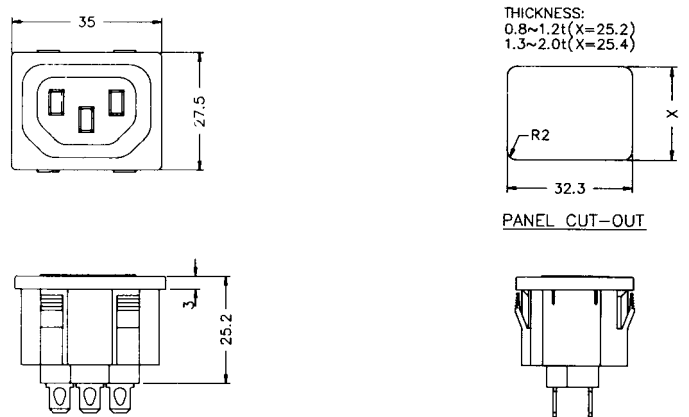
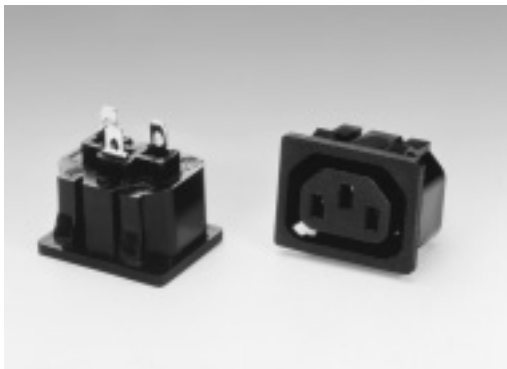

## 0708-1 Rivet/Screw Mounting

